

SmartScan touch plates

SmartScan Dim, SmartScan Scene, SmartScan Switch and SmartScan Colour

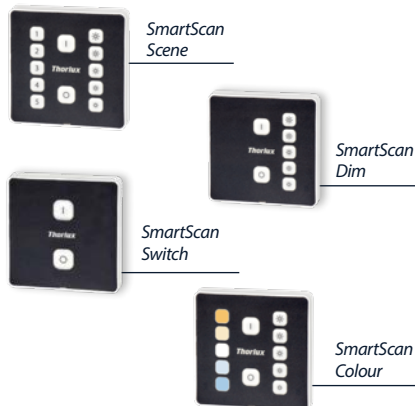

SMARTSCAN TOUCH PLATES



DIMENSIONS

NOTE: Pattress box single gang depth min. 35mm for mains versions only (not supplied)

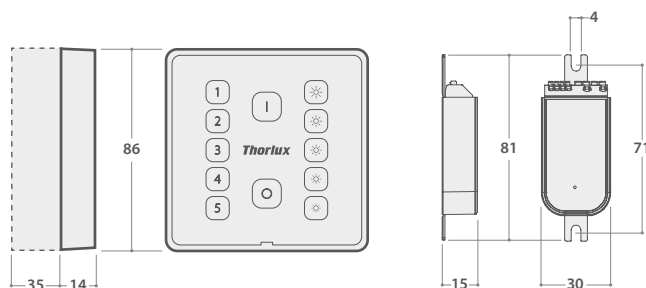

OPERATING INSTRUCTIONS

- The **SmartScan touch plates** allow the user to control a group of SmartScan luminaires.
- Simply touch the desired function.
- The mains powered **SmartScan touch plates** has a wireless connection that allows control of the luminaires using the Thorlux SmartScan App.
- App one time passcode - 0527
- Wireless communications are disabled as default, therefore the **SmartScan touch plates** must be commissioned before use.



Search for **Thorlux SmartScan**

FUNCTIONS

To enter Set Up Mode press any button for 10 seconds. A green LED will illuminate to confirm Set Up Mode.

The **SmartScan touch plates** are programmed using the **SmartScan Programmer**.

Set Up Mode will exit after 60 seconds of inactivity.

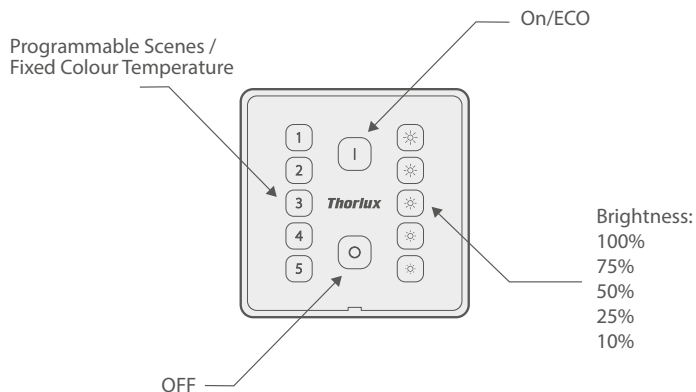

POSITIONING

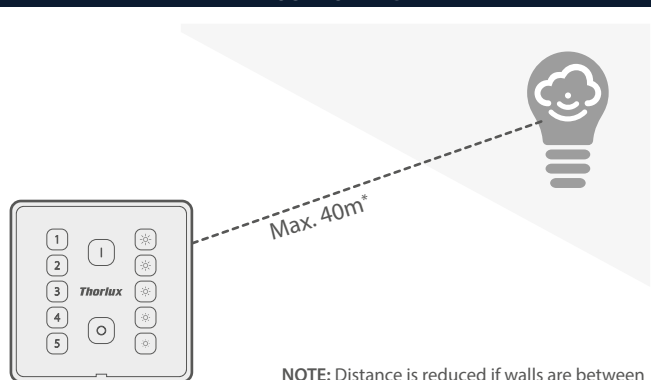

* 922MHz Max. 10m

NOTE: Distance is reduced if walls are between SmartScan Touch and luminaires.

SMARTSCAN PROGRAMMING/TESTING

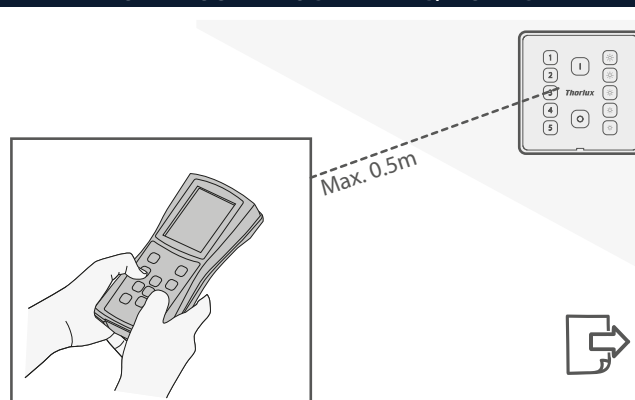

1. REMOVING THE FASCIA

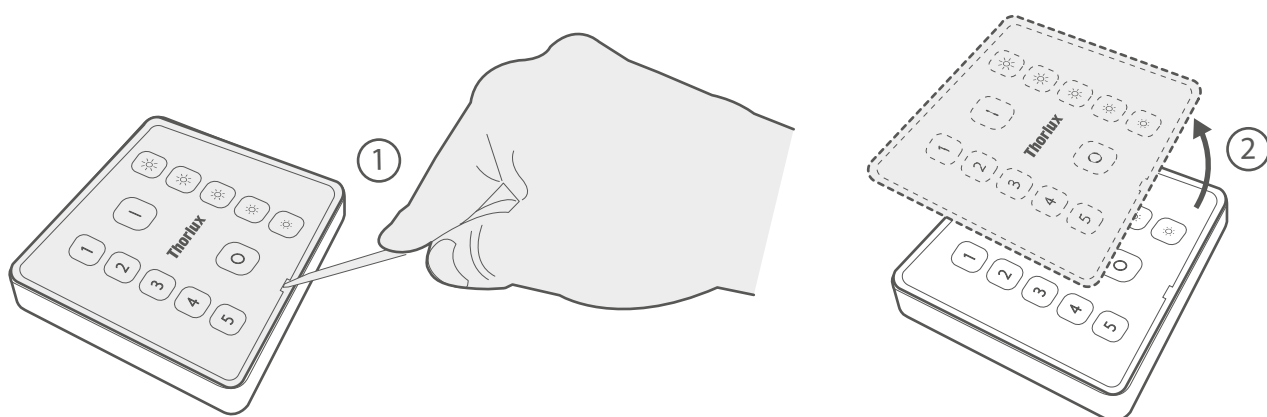

2. BATTERY PLACEMENT AND MAINS WIRING

BATTERY POWERED

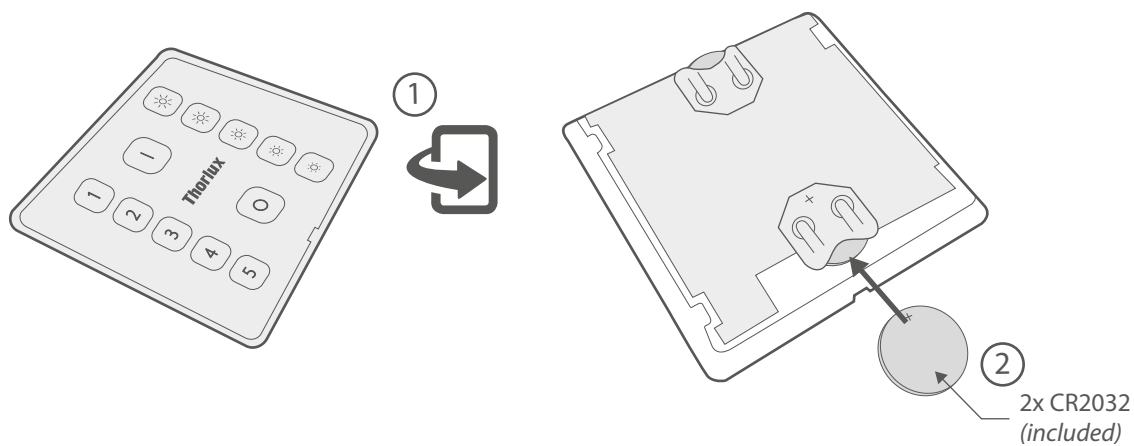

MAINS POWERED

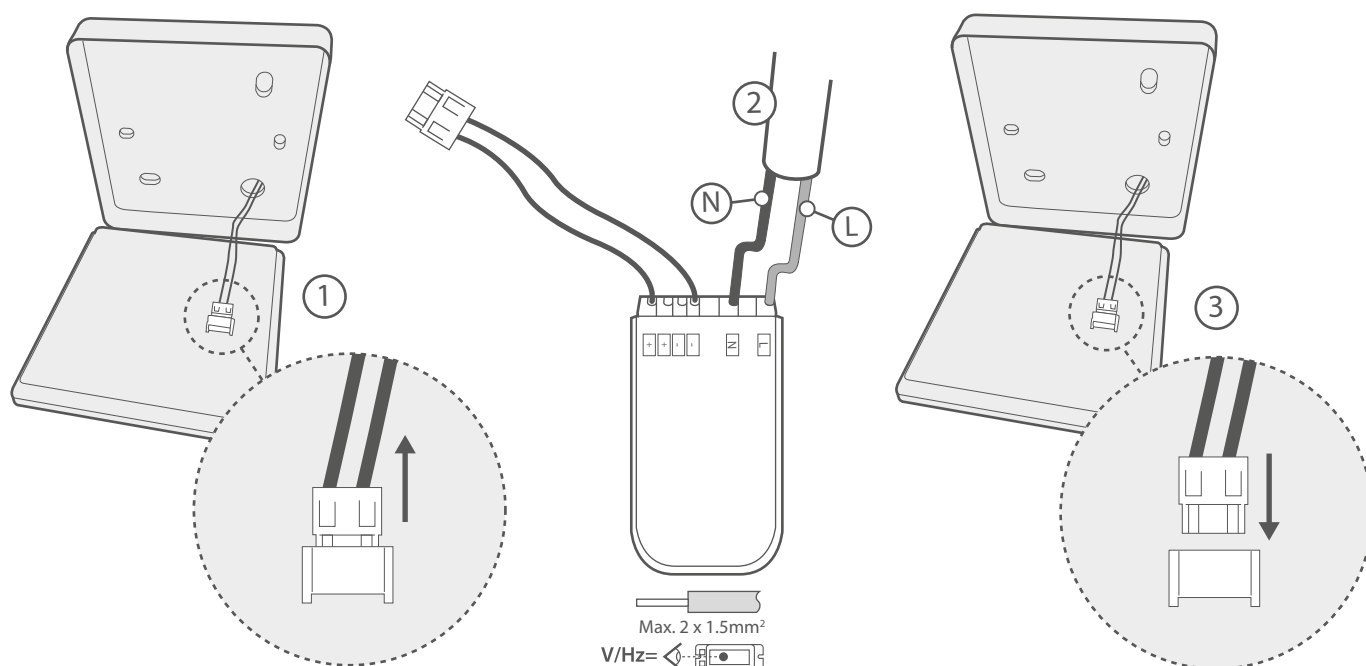

BATTERY POWERED

Recommended use:

ADHESIVE PADS

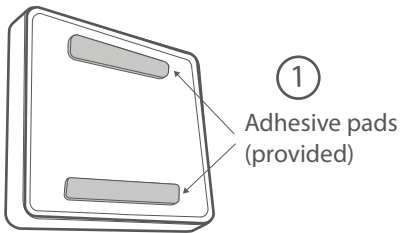

WOOD FIXING

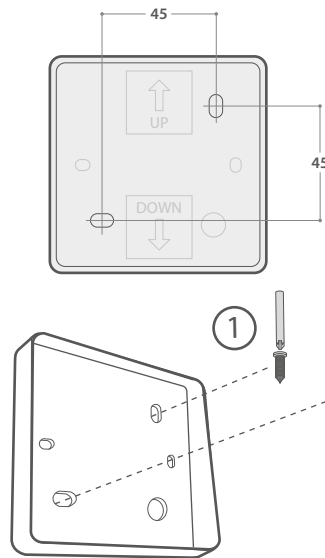

⚠ PLEASE ENSURE CORRECT
FIXING TYPE
2X

PATRESS BOX

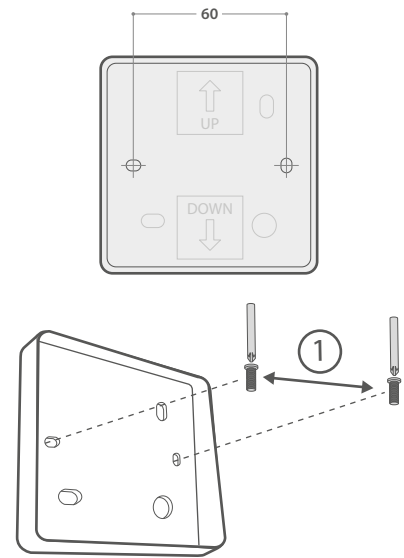

⚠ PLEASE ENSURE CORRECT
FIXING TYPE
2X

MAINS POWERED

Recommended use:

PATRESS BOX

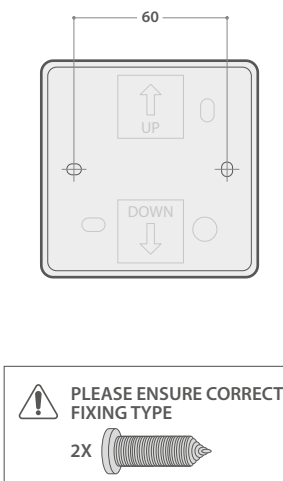

①
Mains in

Pattress box
(not provided)

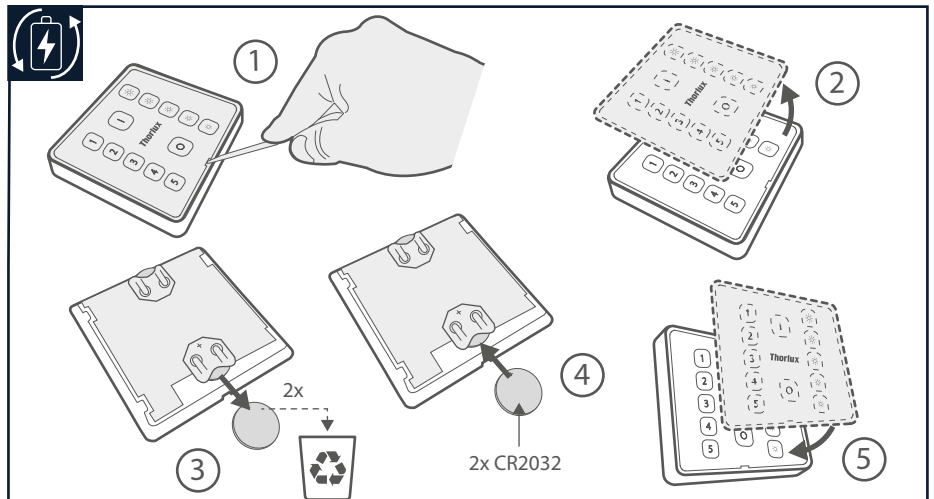
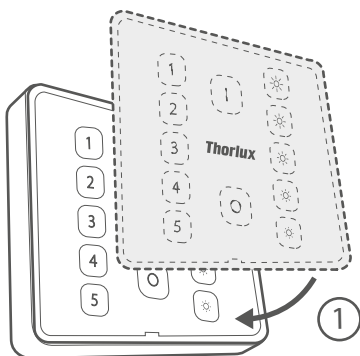
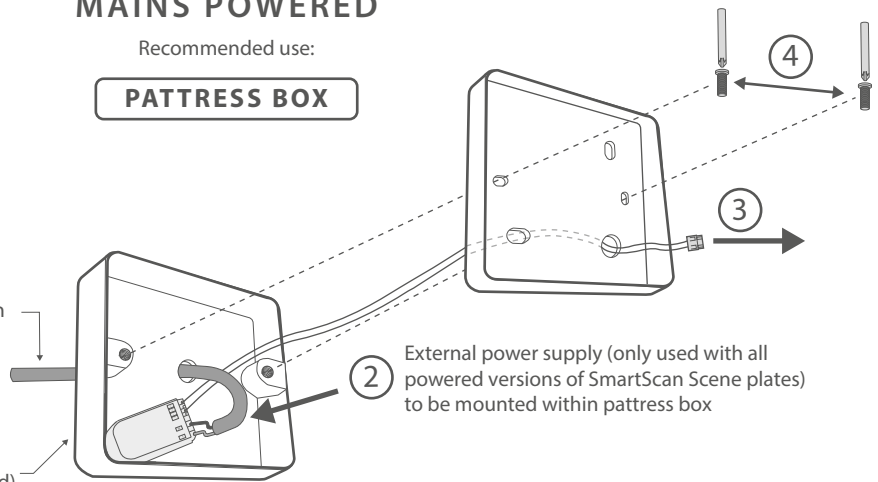

PROGRAMMING

SmartScan touch plates are programmed with the **SmartScan Programmer**. This device uses bi-directional infrared to program the **SmartScan touch plates**. Ensure at all times, during use, only one device can be "seen" by the programmer. Use the SmartScan Emergency Menu.

MODIFICATIONS

Thorlux products should not be modified. Any modification may render the product unsafe and will invalidate any Safety/ Approval marks.

MAINTENANCE

The **SmartScan touch plates** should not be subjected to undue mechanical shock or extremes of temperature. Clean only with a clean dry cloth.

* RF Transmit - can be enabled or disabled from the SmartScan Emergency menu. When disabled all radio transmissions are prohibited.

NOTE: The SmartScan touch plates do not support any other functions from the programmer menu.

SMARTSCAN PROGRAMMER

The **SmartScan Programmer** has six touch pad buttons.

DISPLAY

On the home screen the Internal, External, Emergency and Programmer Set Up menus are displayed.

TECHNICAL DATA

- Dimensions : 198 x 121 x 52mm
- Power : 4-off AA/1.5V Battery (*supplied*)

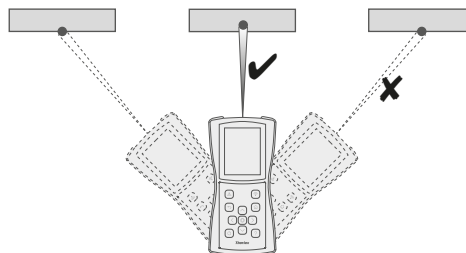

Only one **SmartScan device** in view of the programmer

NOTICE TO CONTRACTOR - PLEASE PASS THIS LEAFLET TO THE END-USER



MERSE ROAD NORTH MOONS MOAT
REDDITCH WORCS. B98 9HH ENGLAND
e-mail: thorlux@thorlux.co.uk
Web: www.thorlux.com
☎ +44 (0)1527 583200

Australia: www.thorlux.com.au ☎ +61 (0)2 9907 1261
Deutschland: www.thorlux.de ☎ +49 (0)2841 39399 10
Ireland: www.thorlux.ie ☎ +353 (0)1 460 4608
UAE: www.thorlux.ae ☎ +971 (0)2 654 4060



ISO 9001
Quality
Management
Systems
CERTIFIED

ISO 14001
Environmental
Management
CERTIFIED

ISO 45001
Occupational
Health and Safety
Management
CERTIFIED

FM 10913

EMS 532104

OHS 704131