

# SmartScan Touch

BATTERY POWERED SS20212 & MAINS POWERED SS20213



## SMARTSCAN TOUCH



## DIMENSIONS

NOTE: Patress box single gang depth min. 35mm for mains versions only (not supplied)

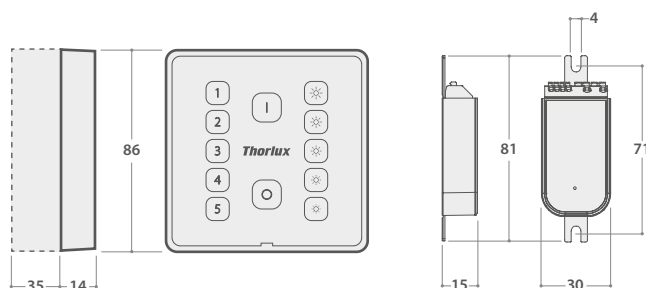

## OPERATING INSTRUCTIONS

- The **SmartScan Touch** allows the user to control a group of SmartScan luminaires.
- Simply touch the desired function.
- The mains powered **SmartScan Touch** has a wireless connection that allows control of the luminaires using the Thorlux SmartScan App.
- Wireless communications are disabled as default, therefore the **SmartScan Touch** must be commissioned before use.



Search for **Thorlux SmartScan**

## FUNCTIONS

To enter Set Up Mode press any button for 10 seconds. A green LED will illuminate to confirm Set Up Mode.

The SmartScan Touch can now be programmed using the SmartScan Programmer (please see page 4 for programming commands).

Set Up Mode will exit after 60 seconds of inactivity.

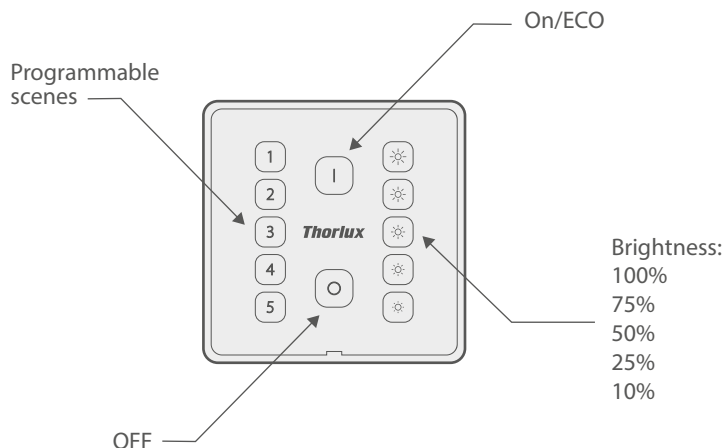

## POSITIONING

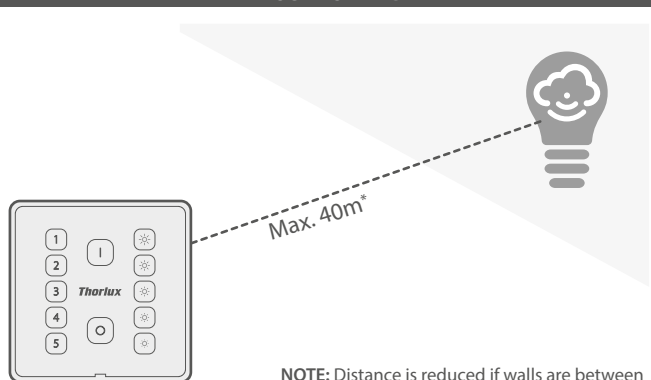

\* 922MHz Max. 10m

NOTE: Distance is reduced if walls are between SmartScan Touch and luminaires.

## SMARTSCAN PROGRAMMING/TESTING

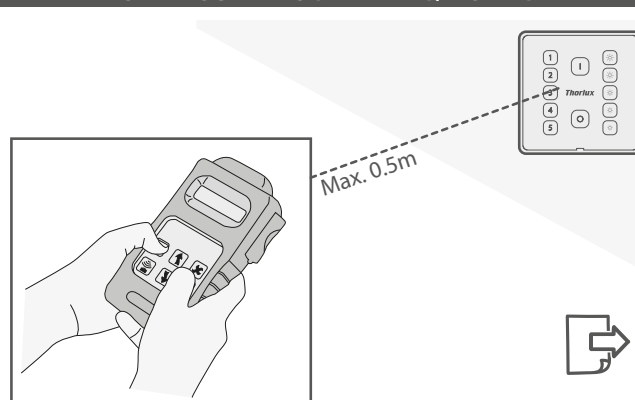

## 1. REMOVING THE TOUCH PANEL

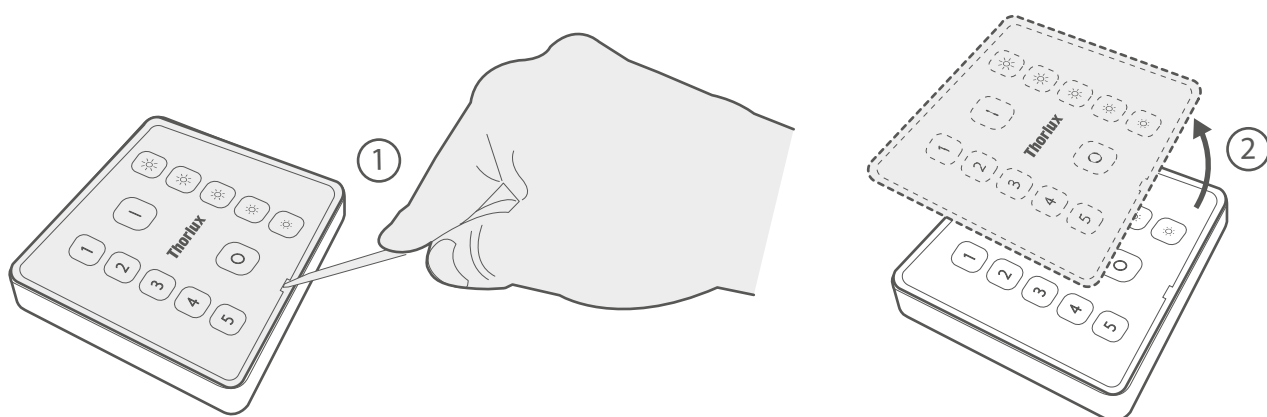

## 2. BATTERY PLACEMENT AND MAINS WIRING

### BATTERY POWERED

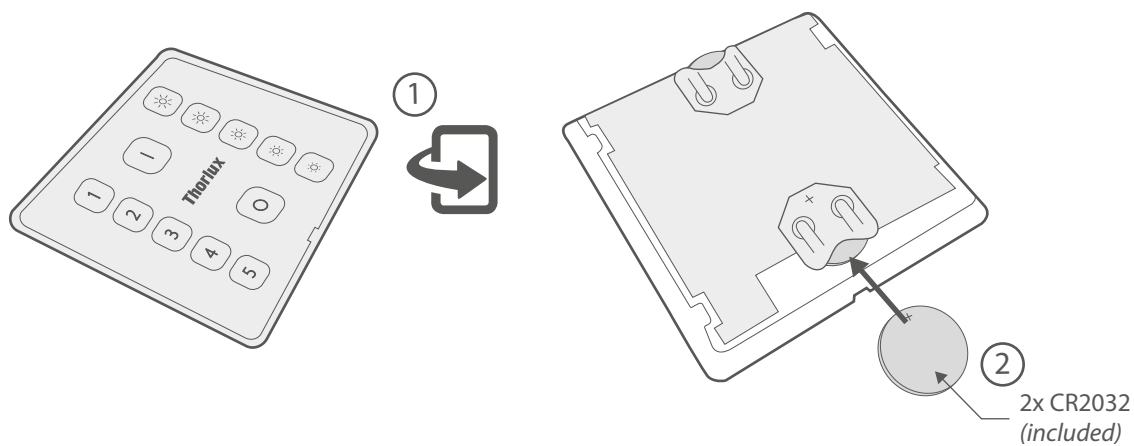

### MAINS POWERED

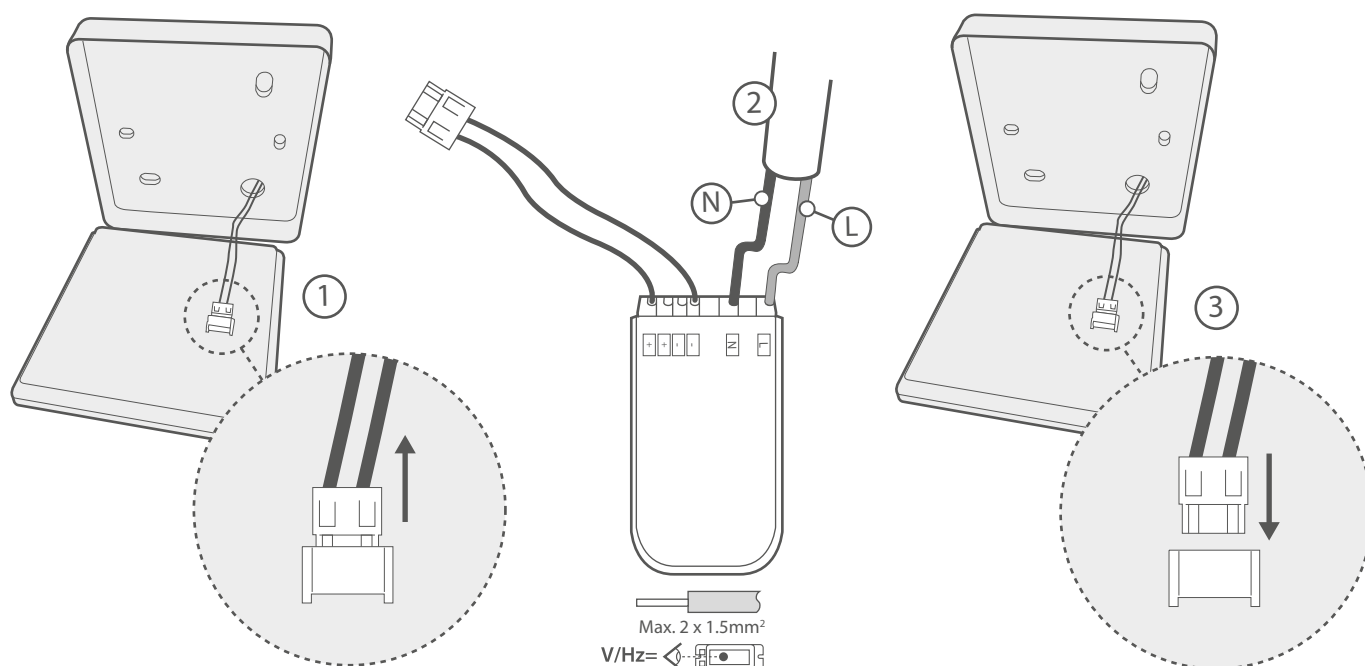

## BATTERY POWERED

Recommended use:

### ADHESIVE PADS

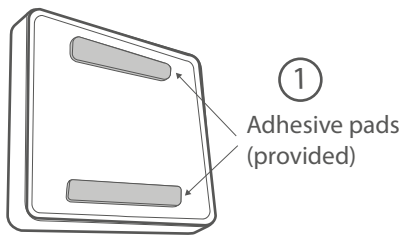

### WOOD FIXING

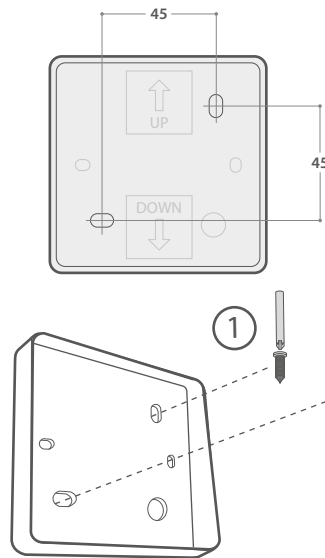

⚠ PLEASE ENSURE CORRECT  
FIXING TYPE  
2X

### PATRESS BOX

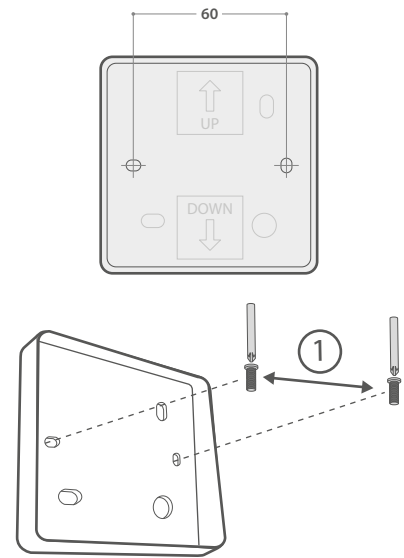

⚠ PLEASE ENSURE CORRECT  
FIXING TYPE  
2X

## MAINS POWERED

Recommended use:

### PATRESS BOX

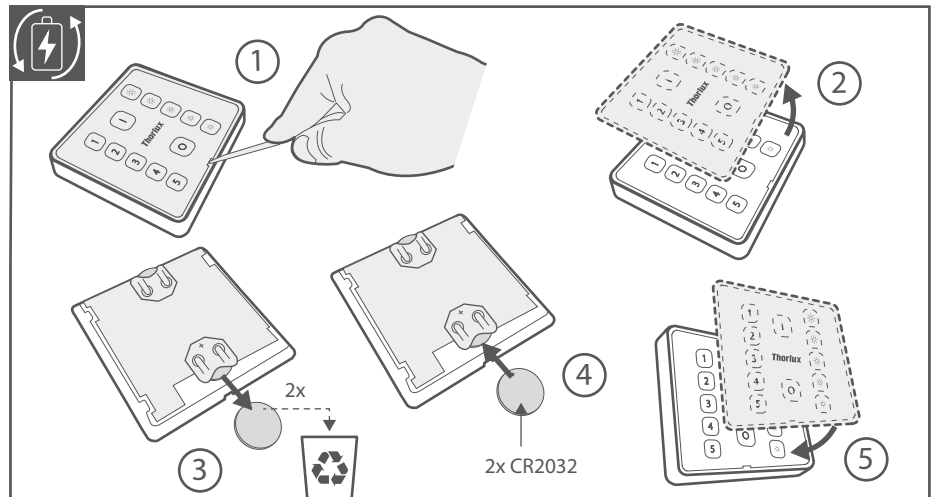
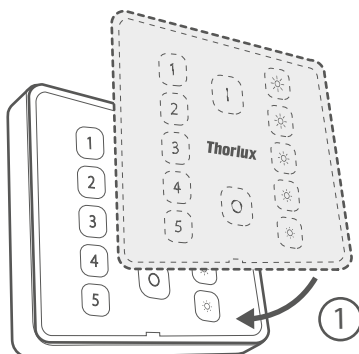
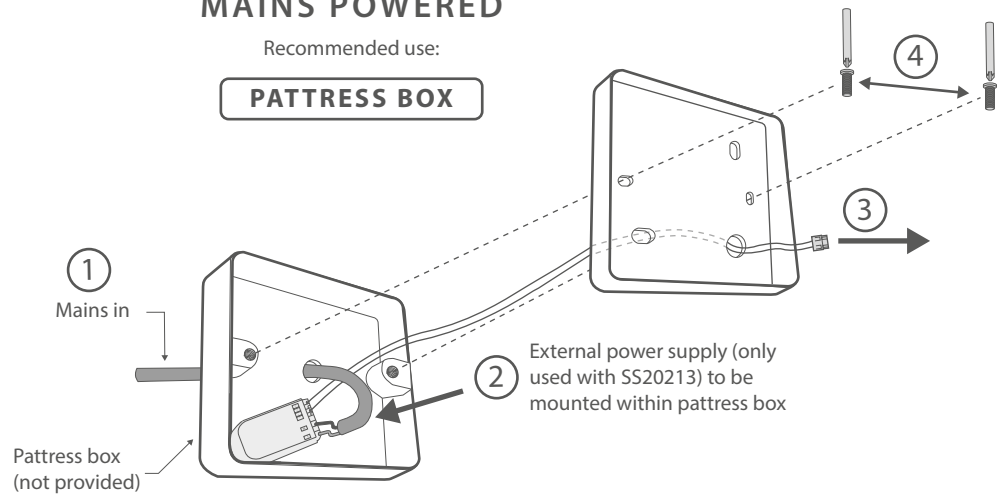
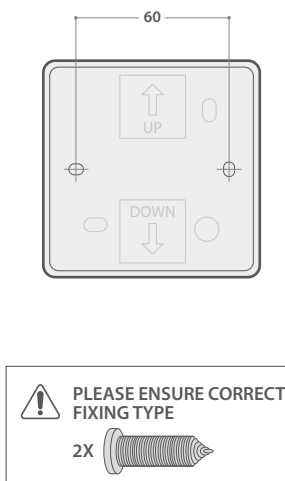

## PROGRAMMING

**SmartScan Touch** is programmed with the SmartScan Programmer. This device uses bi-directional infrared to program the **SmartScan Touch**. Ensure at all times, during use, only one device can be "seen" by the programmer.

### PROGRAMMER

#### DISPLAY

On the first LCD line the actual menu point is displayed. On the second line, the status line, the possible settings for this menu point are shown. During a data transmission, the actual transmission status (as well as any error messages) is shown.

- Power : 4x AA/1.5V battery (supplied)



catalogue no. **LCM 10777SS**

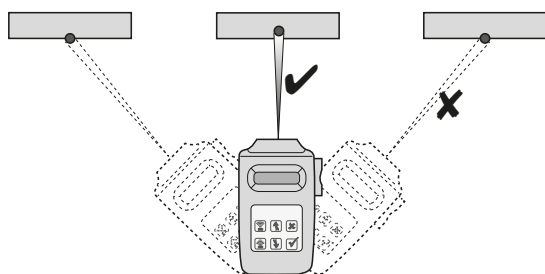

Only one **SmartScan device** in view of the programmer

## MODIFICATIONS

Thorlux products should not be modified. Any modification may render the product unsafe and will invalidate any Safety/Approval marks.

## MAINTENANCE

The **SmartScan Touch** should not be subjected to undue mechanical shock or extremes of temperature. Clean only with a clean dry cloth.

## PROGRAMMING BUILDING ADDRESS AND GROUP ADDRESS

	FUNCTION	BUTTON	DISPLAY
1	Switch on the Smart Programmer		
2	Scroll to the <SmartScan Emergency> menu		<SmartScan Emergency>
3	Select the menu <SmartScan Emergency>		download all <SmartScan Emergency>
4	Scroll to the building setting		building: 123 address 1-254
5	To change the address press the (Select) button. (A star in the upper corner indicates access of the program mode).		building: 123* address 1-254
6	Use the scroll buttons, to select the required address		building: 123* address 1-254
7	The (Send) button will now, update the chosen parameter in the SmartScan Touch		
8	Scroll to group address		group addr: 123 address 1-254
9	Select this parameter. Option name and current status are now displayed on the top line.		group addr: 123* address 1-254
10	Use the scroll buttons, to select the required address		group addr: 123* address 1-254
11	The (Send) button will now, update the chosen parameter in the SmartScan Touch		
12	Scroll to RF transmit		rf transmit: en enable/disable
13	To change between enable and disable press the (Select) button		rf transmit: en* enable/disable
14	Use the scroll buttons, to select the required function		rf transmit: en* enable/disable
15	The (Send) button will now, update the chosen parameter in the SmartScan Touch		
12	To exit the setting mode press (Esc). The new selected value will now be displayed on the first line.		group addr: 123 address 1-254
Now all parameters are memorised in the SmartScan Touch			

\* RF Transmit - can be enabled or disabled from the SmartScan Emergency menu. When disabled all radio transmissions are prohibited.

**NOTE:** The SmartScan Touch does not support any other functions from the programmer menu.

## NOTICE TO CONTRACTOR - PLEASE PASS THIS LEAFLET TO THE END-USER



MERSE ROAD NORTH MOONS MOAT  
REDDITCH WORCS. B98 9HH ENGLAND  
e-mail: [thorlux@thorlux.co.uk](mailto:thorlux@thorlux.co.uk)  
Web: [www.thorlux.com](http://www.thorlux.com)  
+44 (0)1527 583200

Australia: [www.thorlux.com.au](http://www.thorlux.com.au) ☎ +61 (0)2 9907 1261  
Deutschland: [www.thorlux.de](http://www.thorlux.de) ☎ +49 (0)211 6956 0310  
Ireland: [www.thorlux.ie](http://www.thorlux.ie) ☎ +353 (0)1 460 4608  
UAE: [www.thorlux.ae](http://www.thorlux.ae) ☎ +971 (0)2 654 4060



FM 10913 EMS 532104 OHS 704131