

Smart Touch (Conventionally Wired)

Regular, Teaching and Meeting Versions

INSTALLATION DETAILS



SMART TOUCH CONVENTIONAL



Regular: **LCM 14813**

Teaching: **LCM 14814**

Meeting: **LCM 14815**

OPERATING INSTRUCTIONS

- The **SmartTouch** allows the user to control a group of Smart luminaires.
- Simply touch the desired function.
- An indicator LED will highlight the current status.



DIMENSIONS

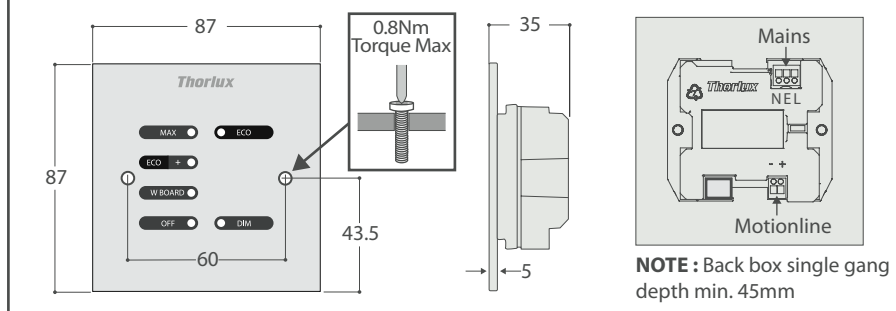

FUNCTIONS

Function

- A** Smart luminaires to maximum
- B** Return to automatic
- C** Smart luminaires synchronise then dim

Function (Default Settings)

- 1** Scene 1 - Smart luminaires to 50% fixed
- 2** Scene 2 - Smart luminaires to 25% fixed
- 3** Scene 3 - Smart luminaires OFF

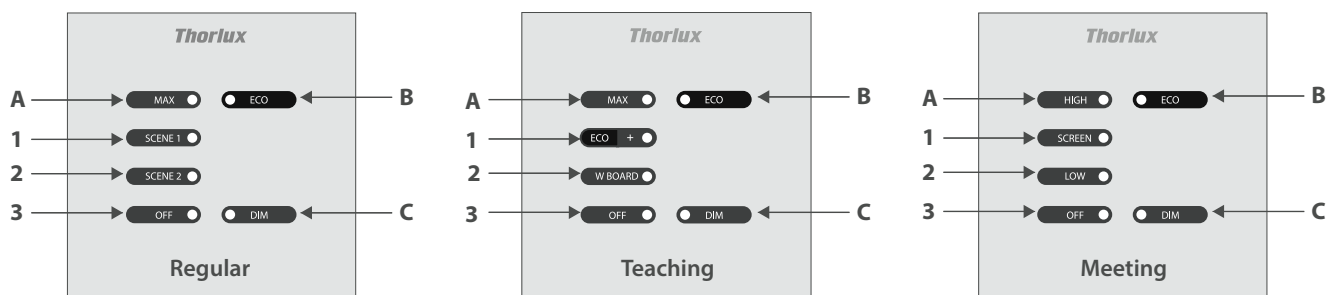

LUMINAIRE WIRING

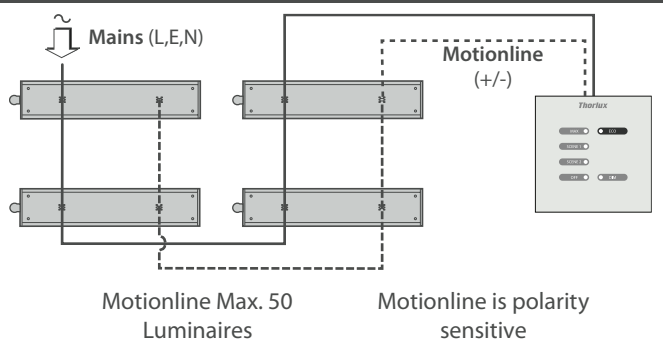

MOTIONLINE WIRING

NOTE: To insert the Motionline wiring the button must be pressed down

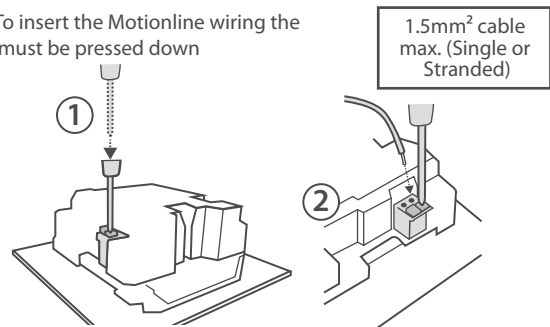

MODIFICATIONS

Thorlux products should not be modified. Any modification may render the product unsafe and will invalidate any Safety/Approval marks.

MAINTENANCE

The **ECO SmartTouch** should not be subjected to undue mechanical shock or extremes of temperature. Clean only with a clean dry cloth.

NOTICE TO CONTRACTOR - PLEASE PASS THIS LEAFLET TO THE END-USER



MERSE ROAD NORTH MOONS MOAT
REDDITCH WORCS. B98 9HH ENGLAND
e-mail: thorlux@thorlux.co.uk
Web: www.thorlux.com
+44 (0)1527 583200

Australia: www.thorlux.com.au ☎ +61 (0)2 9907 1261
Germany: www.thorlux.de ☎ +49 (0)211 6956 0310
Ireland: www.thorlux.ie ☎ +353 (0)1 460 4608
UAE: www.thorlux.ae ☎ +971 (0)2 656 5842



FM 10913 EMS 532104