

# HI-STYLE LED

LG7:2015 VERSION  
OFFERS BALANCED GLARE  
CONTROL, WHILST STILL  
PROVIDING EXCELLENT  
WALL ILLUMINATION

## PERFORMANCE GUIDE

Typical task area illuminance assuming an open area with good reflection factors, 0.85 maintenance factor and a 2.65 metre ceiling height.

OPEN PLAN	LG7:2015 LED	SPACING (Metres)	LUX AVERAGE 70/50/20	LUX AVERAGE 80/60/30
	16W	3.0 x 2.4		280
2.4 x 2.4			340	380
24W	3.0 x 2.4		420	480
	2.4 x 2.4		510	580
34W	3.0 x 2.4		550	620
	2.4 x 2.4		660	750

OPEN PLAN	OPAL	SPACING (Metres)	LUX AVERAGE 70/50/20	LUX AVERAGE 80/60/30
	16W	3.0 x 2.4		285
2.4 x 2.4			345	390
24W	3.0 x 2.4		430	490
	2.4 x 2.4		520	590
34W	3.0 x 2.4		555	630
	2.4 x 2.4		670	760

## DIMENSIONS

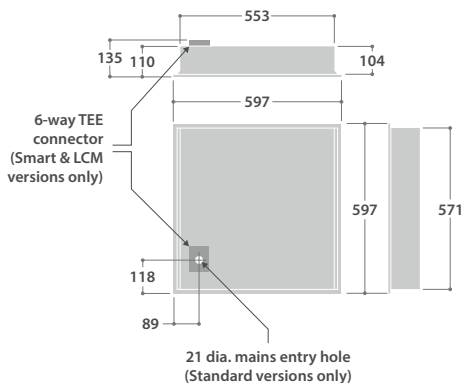

## PHOTOMETRIC GUIDE

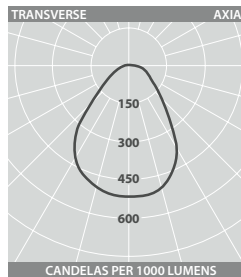

**LG7:2015 LED**  
Luminaire Lumen Output  
16W = 2125lm  
24W = 3200lm  
34W = 4150lm

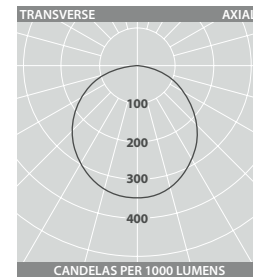

**OPAL**  
Luminaire Lumen Output  
16W = 2220lm  
24W = 3345lm  
34W = 4340lm



## HIGH PERFORMANCE RECESSED LED LUMINAIRES



### SPECIFICATION

- Steel body finished full polyester non-yellowing satin white (RAL 9016)
- Carefully controlled optics for LG7:2015 (<math><3000\text{ cd/m}^2\text{ @ }65^\circ</math>) compliance or fire retardant polycarbonate opal diffuser version
- Excellent wall illumination at high angles
- Balanced direct/indirect luminance control above  $65^\circ$
- Suitable for most ceiling types; lay-in or pull up with optional side arm suspensions
- Extruded side diffusers give vibrant yet low glare aesthetics
- Body depth 110mm
- Designed to exclude dust, dirt and flies. All control gear is outside the LED enclosure
- 500 x 500mm and air-handling versions available to special order
- Optional SmartScan wireless technology removes the need for control cabling. Ideal for retro-fit.
- Fitted with 4000K LED(s)

### Smart Range

- Integral Smart Sensor fixed into cover
- Rapid connection using plugged connecting leads

### LED CHARACTERISTICS

Ra 80+	°K 4000	L80/B10 60K	LL/CW LG7:2015 118.5 OPAL 123.9
P/U P	% >85	R/Rx R	PF >0.9

For LED characteristics explanation see [www.thorlux.com/led-characteristics](http://www.thorlux.com/led-characteristics)



### RANGE

	NOMINAL SIZE (mm)	LED	LG7:2015	OPAL	APPROX. kg	CIRCUIT
SMART	600 x 600	16W	HI 17224	HI 17791	4.9	D/SS
		24W	HI 17225	HI 17792	4.9	D/SS
		34W	HI 17226	HI 17793	4.9	D/SS
STANDARD	600 x 600	16W	HI 17227	HI 17794	4.8	L/A
		24W	HI 17228	HI 17795	4.8	L/A
		34W	HI 17229	HI 17796	4.8	L/A

CIRCUIT TYPE - suffix catalogue number with:

**SMART** D - Smart / SS - SmartScan

**STANDARD** L - non-dimming (LED) / A - dimming (DALI) e.g. HI 17224SS etc.

EMERGENCY VERSION - prefix catalogue number with:

EHI - Emergency / THI - AutoTest e.g. EHI 17227L etc.

Add 0.3kg to weights listed

### ACCESSORIES

DESCRIPTION	CAT. No.
Optional side arm suspension kit ▲	HI 12349

▲ 4 arms per kit - not required for lay-in mounting

**WEB LINK >**  
"PLUG AND PLAY"  
LIGHTING CABLE  
MANAGEMENT



Learn more about  
SmartScan at:  
[www.thorlux.com/smartscan](http://www.thorlux.com/smartscan)

# HI-STYLE LED

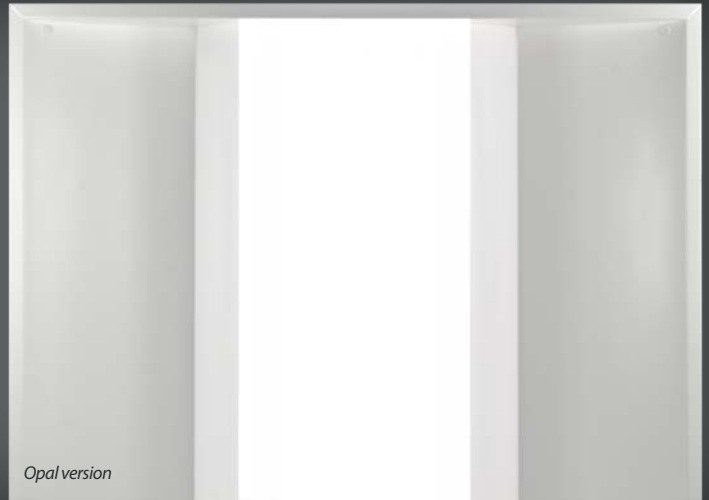
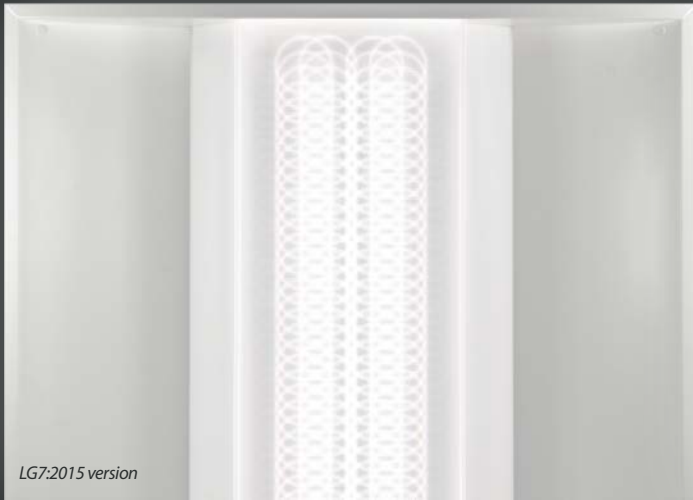

## MOUNTING ARRANGEMENTS

Exposed T-bar  
(15 or 24)

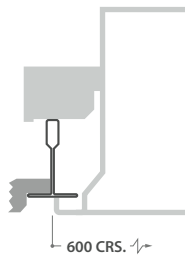

Spring Tee

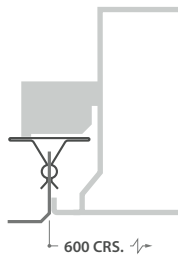

Concealed

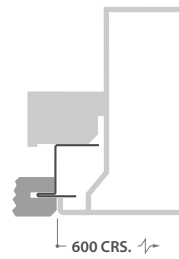

Lay-in on Exposed T-bar  
(15 or 24)

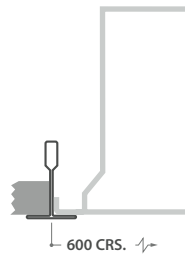

Plasterboard Ceiling

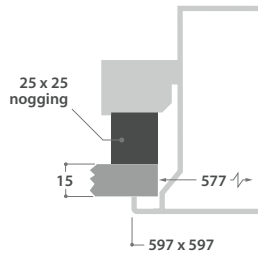

Side arm suspension  
adjustment range

